

FUNC VERTY

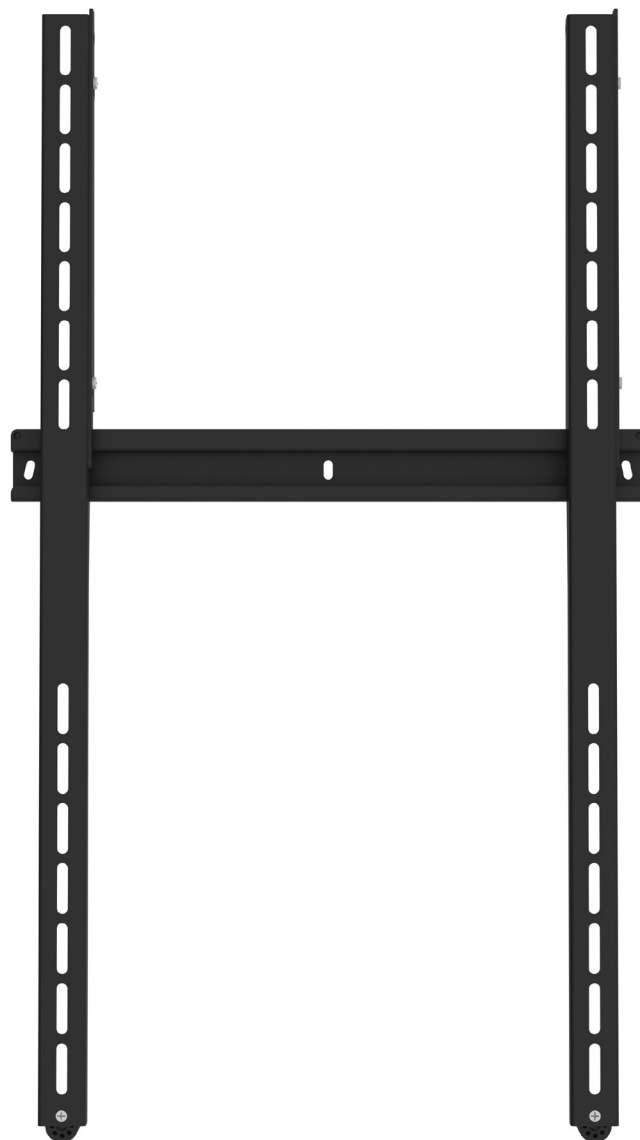

A universal wall bracket that is easy to mount, suitable for the portrait mounting of screens of dimension up to 55". The hole pattern fits exactly between two wall studs. It can be locked by a locking pin or padlock for improved personal safety and security from theft. Suitable for Vesa hole patterns with maximum dimensions 800 x 400 mm and minimum dimensions 200 x 200 mm.

INFO

- Finish: Black
- Max. load: 50 kg.
- Weight: 2.6 kg.
- Suitable for screens up to 55".
- Size (bracket, B x H x D): 458 x 800 x 35 mm.

ART. NR
PL020052

DESCRIPTION
Func Verty Black

Suitable for Vesa standards: Minimum 200 x 200 mm, maximum 800 x 400 mm.

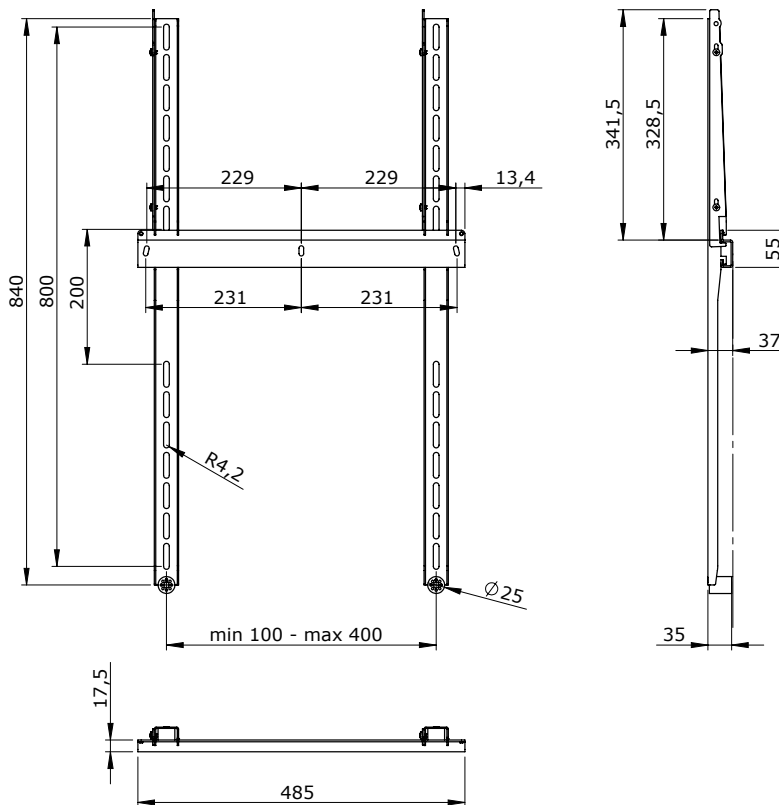

A003517A - We reserve the right to introduce changes in the product specifications after the printing and publication of this document.